

SURFACES

PANEL PLUS SURFACES 001
SUR-PNP-001

CSI
Creative

PRODUCT GUIDE

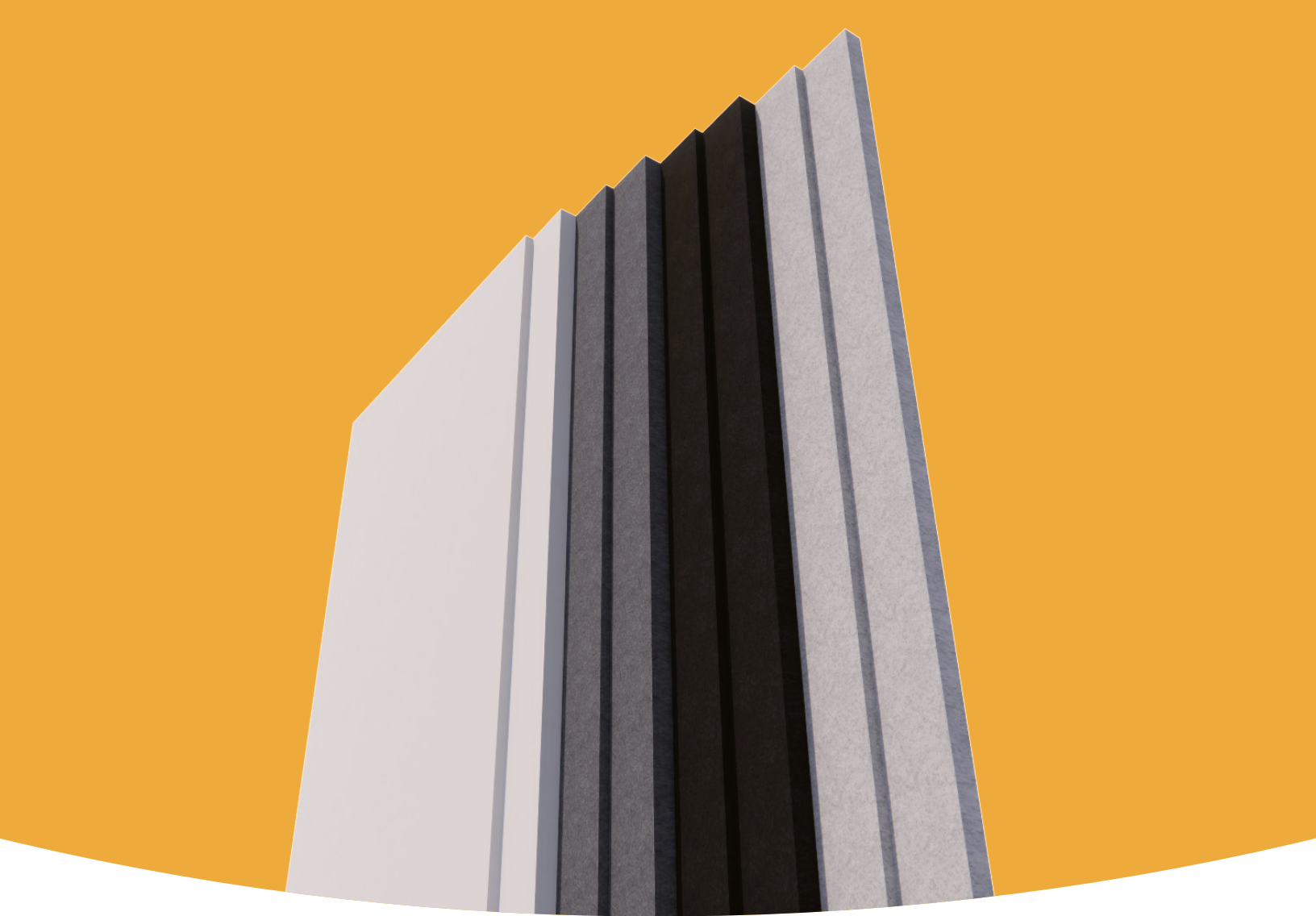

LIGHTWEIGHT

Super light material opens up options for ceilings and surfaces.



POWERFUL ACOUSTICS

High Noise Reduction Coefficient.



FIRE-SAFE

ASTM E84: Class A tested and compliant.



VOC FREE

CDPH Standard Method V1.2 School Classroom and Private Office Compliant.



CUSTOM SIZING

Custom-sized products arrive installation ready.



SUSTAINABILITY

Made from 60% recycled content and is 100% recyclable.



LOW MAINTENANCE

A light dusting is all you'll ever need.



LEAD TIME

2-4 weeks with vast color options.



SPECIFICATIONS

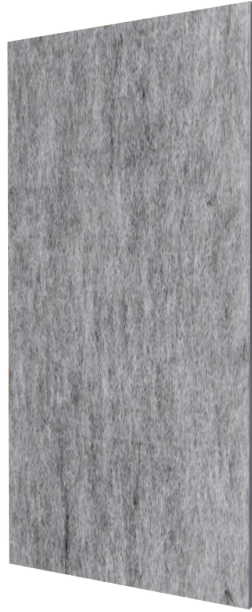

PRODUCT ID	SUR-PNP-001
CONTENT	Soundcore® Recycled PET felt board
DURABILITY	Impact resistant, shock absorbant
WEATHERING	Non-deteriorating, non-hygroscopic, colorfast
MAINTENANCE	Clean with vacuum or light dusting
WARRANTY	Comes with industry-leading standard warranty
ENVIRONMENTAL	100% biodegradable/compostable, contains no formaldehyde, 100% VOC free, no chemical irritants, and free of harmful substances
INSTALLATION	CSI Installation Systems are product specific (see Installation page)
ACOUSTICS	0.70 NRC (1"), 1.05 NRC (2")
FLAMMABILITY	ASTM E84: Class A

TECHNICAL

LENGTH

48"
Uncut factory edge

WIDTH

1" or 2"
Uncut factory edge

HEIGHT

96"
Uncut factory edge

MATERIAL THICKNESS

1" or 2"

SPACING

varies

EDGE

Exposed or covered

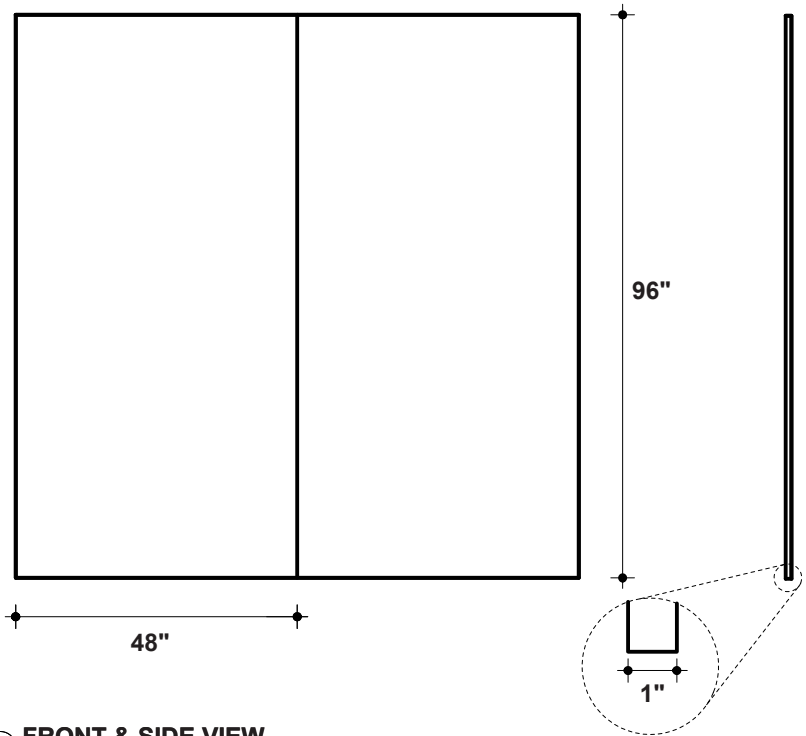

① FRONT & SIDE VIEW



② TOP VIEW

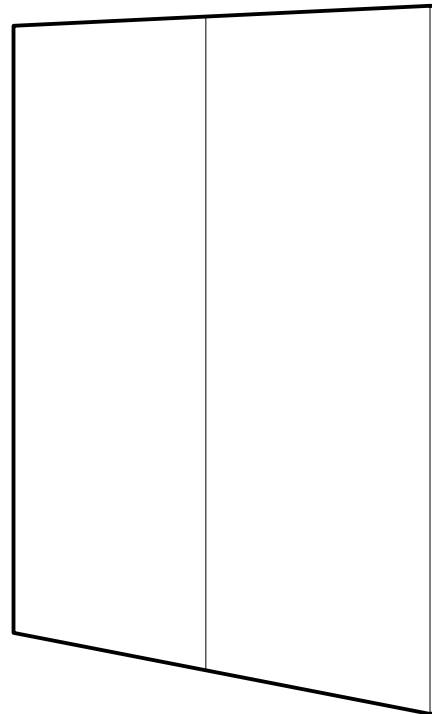

③ PERSPECTIVE VIEW



INSTALLATION

Surface installation systems are designed according to site conditions, and maximize efficiency of installation.

Each solution respects the integrity of the project design, budget, and installs easily with simple tools.

DIRECT ATTACHMENT SYSTEM

Attachment solution for pre-constructed ceiling substrates using construction adhesives. Requires minimal skilled installation labor. Ideal for remodeling spaces.

PEEL AND STICK SYSTEM

Attachment solution for existing surfaces or substrates using pre-applied adhesive backing. Requires minimal skilled installation labor - simply peel, and stick.

INDIVIDUAL CLIP SYSTEM

Attachment system for hanging multiple panels in series efficiently. Maintains alignment of panels with a drop-in gravity clip system. Easily installed in post-construction phase.

SNAP MOUNT SYSTEM

Attachment system for efficient installation via pre-designed modular configurations using snap-locking hardware. Engage us in the design phase for site-specific templates and hardware configurations.

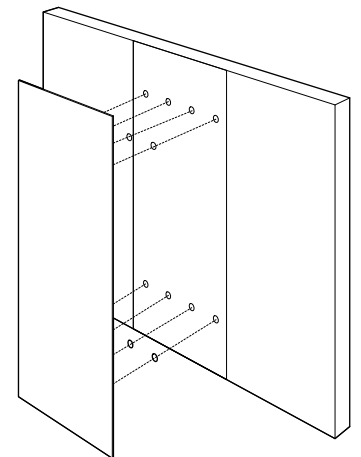
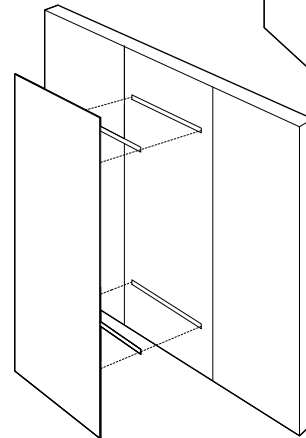
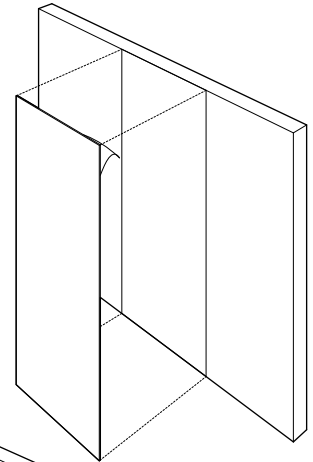
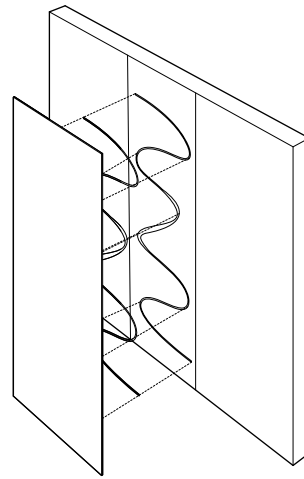

SITE CONDITIONS

TRANSITION

Surface installations in transition areas are typically simple, low-profile cladding that uses color to assist in wayfinding, and enhances the acoustics of hard surfaces in hallways.

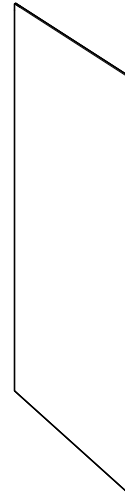

FOCAL POINT

Surface cladding used as a focal point can be infinitely more complex, and can integrate other materials. A focal point gets much more visual attention than transition spaces, and serves artistic merit as well as acoustics.

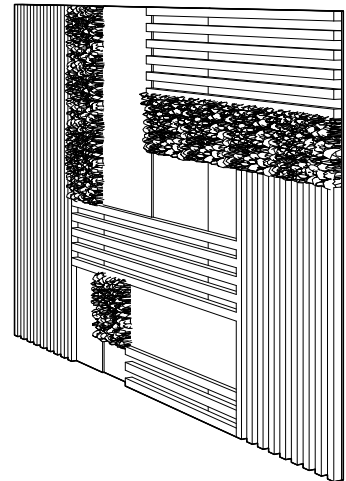

BRANDING

Any product can be designed with integrated branding opportunities, from color choices to lettering, carving, graphic displays and more.

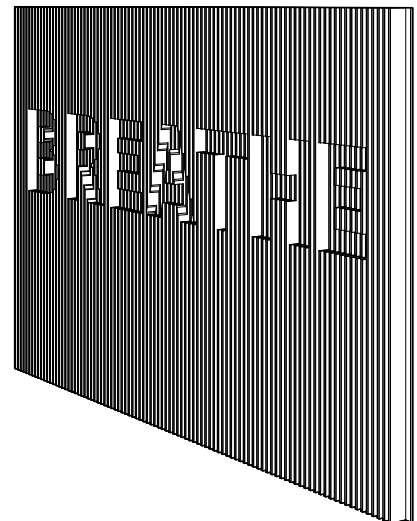

COLORWAYS

SOUNDCORE® PLUS EXTRA THICK RECYCLED PET ACOUSTIC FELT

PREMIER COLORS | 1" & 2", 4' X 8'



SND902 Anthracite

SND904 Timber Wolf

SND901 Sterling

SND905 Feldspar

SND903 Quartz

SND900 Polar

SECONDARY COLORS | 1" & 2", 4' X 8' | Call for lead times and minimum orders



SND912 Snapper

SND913 Cherry

SND914 Zinnia

SND916 Starfruit

SND915 Honeysuckle

SND917 Vintage Mint

SND918 Palawan

SND919 Azure

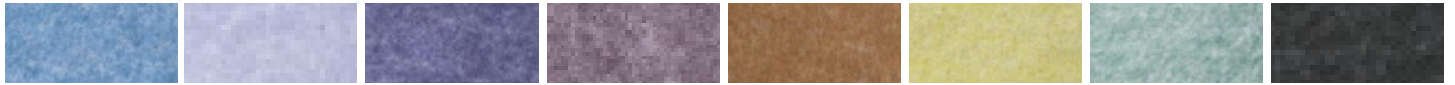

SND920 Blue Racer

SND922 Hyacinth

SND921 Currant

SND923 Bellflower

SND907 Mule Deer

SND908 Fern Moss

SND909 Serpent

SND910 Cypress



SND911 Blush

SND906 Sandy Marble



SUSTAINABILITY



RESPONSIBLE INNOVATION

We source our materials responsibly, using 100% recyclable materials. The majority of the material composition comes from post-consumer plastics, which means you're not forwarding the environmental bill to the next generation.

Soundcore® is 100% VOC free (Volatile Organic Compound), which means from day one there will be zero odorous fumes, and zero air toxicity. It's also ASTM E84: Class A fire rated and offers resonant insulation to build a more comfortable environment.

All of these check-boxes make up a surprisingly lightweight, soft-touch panel that we're incredibly proud of.

MATERIAL CONSTRUCTION

60% Recycled PET acoustic fiber.

PRODUCT CERTIFICATIONS

ASTM E84: Class A, VOC Free (CDPH Standard Method V1.2)



OUR MISSION

EXPERIENTIAL SPACES

Our goal is to create spaces that feel better.

It's easy to visualize a space with architectural acoustics, but even the most detailed renderings couldn't convey the experience of actually being there. When sound is properly controlled within a space, it creates focus and calmness that you can actually feel. We want to help you turn off the droning machinery in the back of your mind. We fabricate custom solutions that visually suit your space while building towards a more soothing holistic experience. This creates spaces where people want to be—where they want to work, where they want to sleep, exercise, create, study, and relax.

