

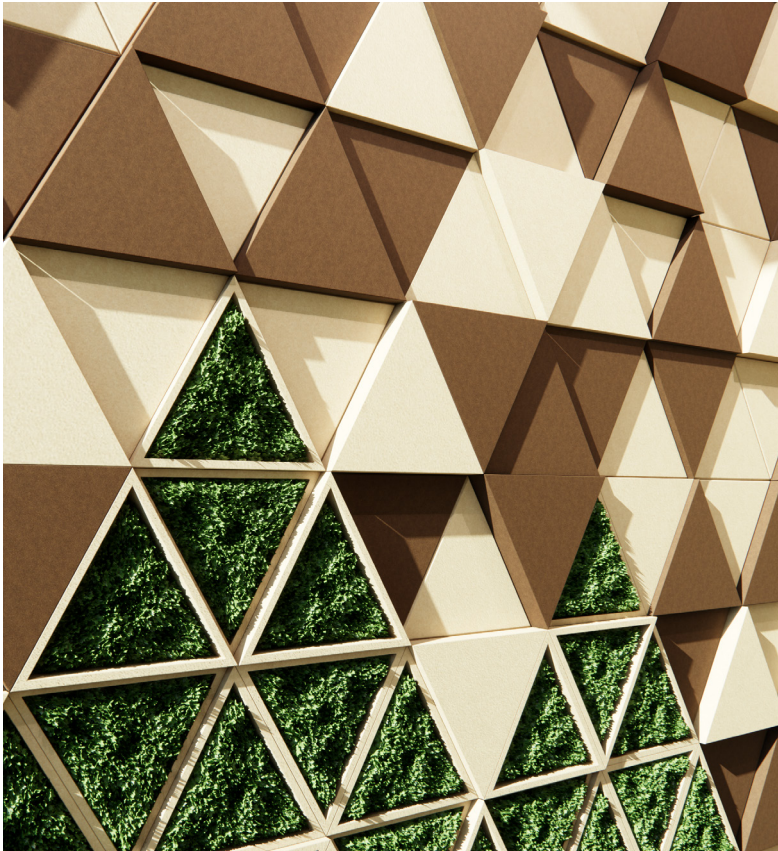

**GEO LEAF**



**CSI  
Creative**



## WALLS GEO LEAF

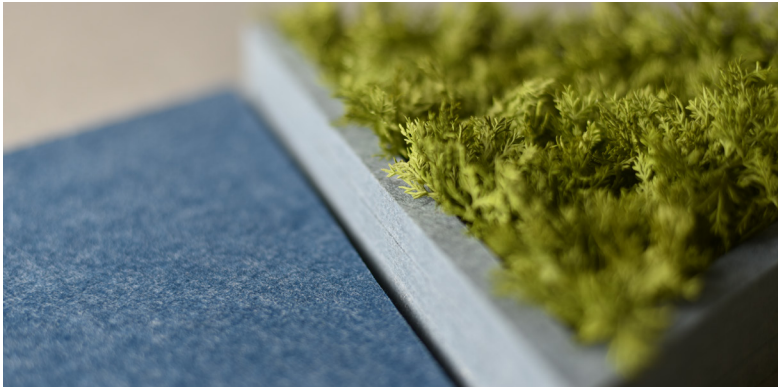
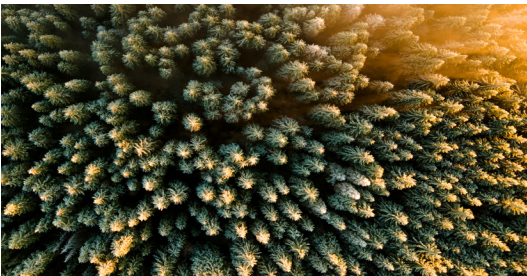

## NATURAL PATTERN

Nature's geometry reveals patterns of harmony, efficiency, and beauty, from spiraling shells to fractal trees. These forms inspire creativity, showing how order and artistry coexist. Bring these timeless, proven themes to any space with EQUI wall tiles

# Configuration

## Design for Every Mood

GeoLeaf tile triangular form allows for dynamic layouts, each influencing the ambiance differently. Evenly spaced, GeoLeaf creates a rhythmic pattern, playful and stimulating. Stacked or layered triangular tiles at varying depths, create a 3D sculptural effect.

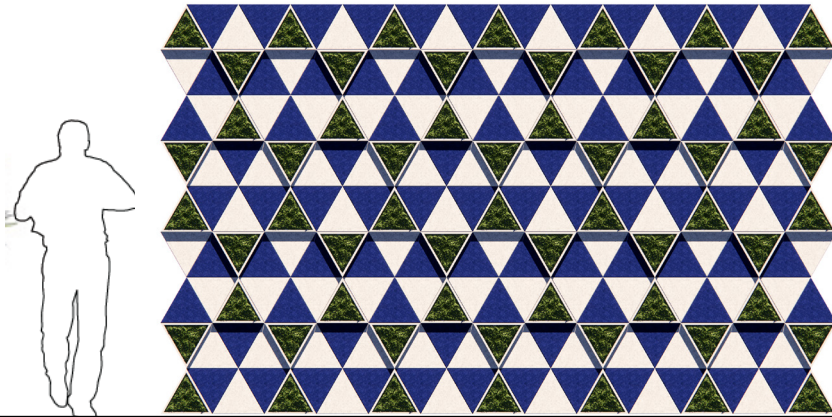

Patterned | 40Greenery/60 Acoustic

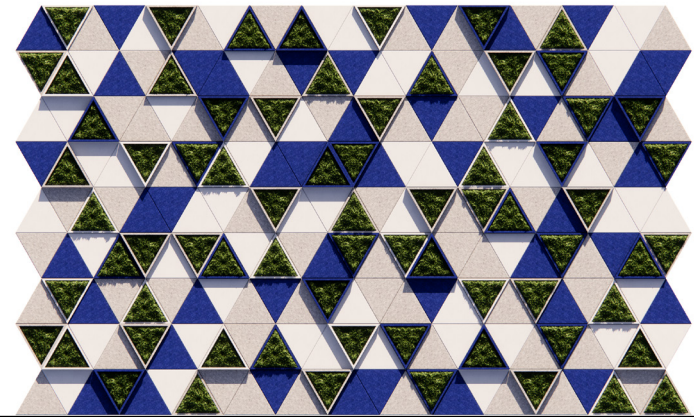

Random | 40Greenery/60 Acoustic

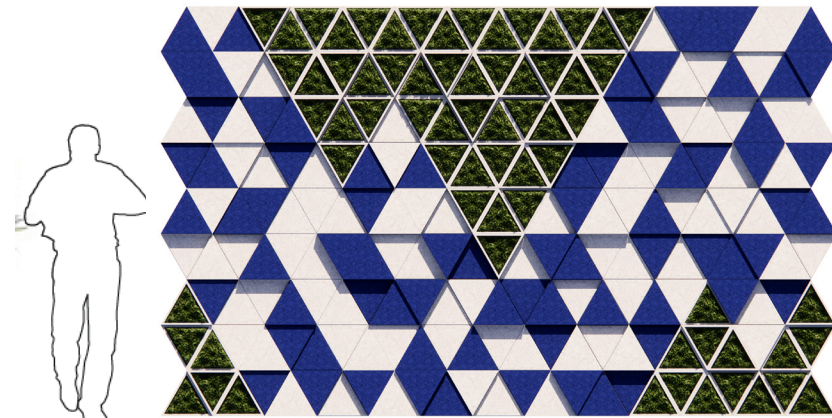

Geometrically Defined | 40Greenery/60

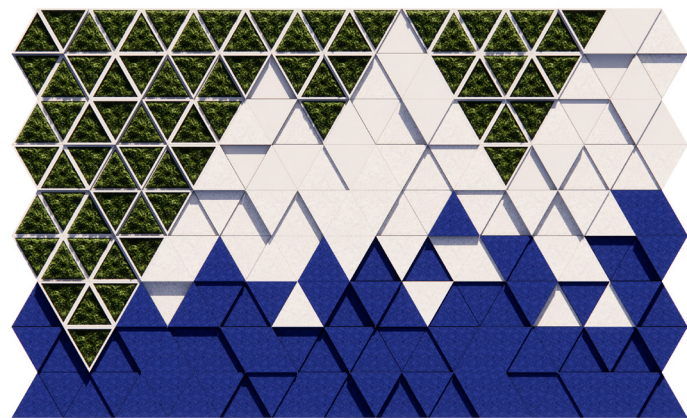

Acoustically dense | 40Greenery/60

# Configuration Design for Every Mood

The GeoLeaf Triangular Tile made of acoustic greenery introduces a unique spatial impact in an interior-designed space by combining geometric precision with organic elements. Its material composition promotes acoustic performance and Sound Softening

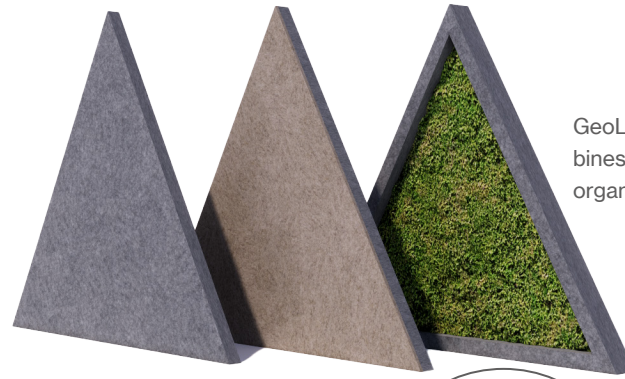
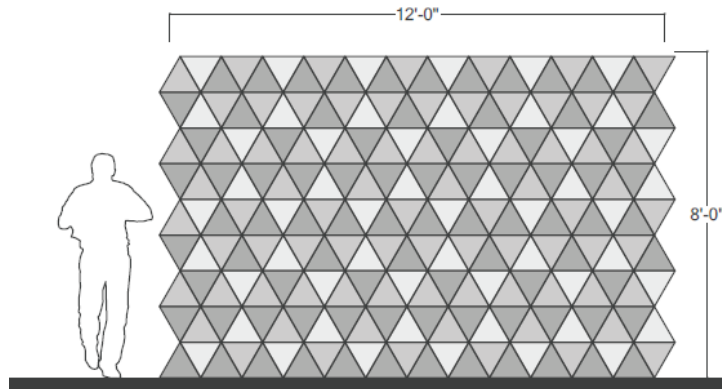

GeoLeaf materiality combines Acoustic, Tactile and organic layers of composition

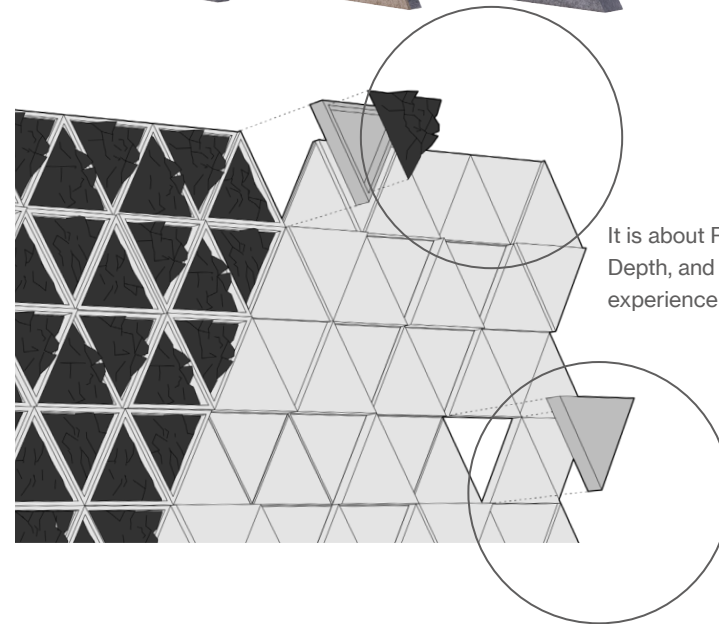
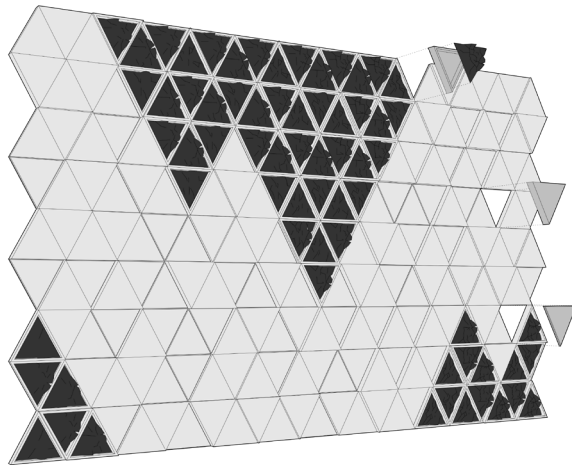

It is about Rhythm, Depth, and tactile experience

# Acoustic Greenery

## Specifications Acoustic Felt

<b>PRODUCT ID</b>	SUR-STK-050
<b>CONTENT</b>	Soundcore® Recycled PET acoustic felt, Thermaleaf® Inherently Fire Retardant Foliage, and Elements veneered Recycled PET Acoustic Felt
<b>DURABILITY</b>	Impact resistant, shock absorbant
<b>WEATHERING</b>	Non-deteriorating, non-hygroscopic, colorfast
<b>MAINTENANCE</b>	Clean with vacuum or light dusting
<b>WARRANTY</b>	Comes with industry-leading standard warranty
<b>ENVIRONMENTAL</b>	LEEDv4, VOC free, 100% recyclable, non-toxic, non-allergenic, anti-microbial
<b>INSTALLATION</b>	CSI Installation Systems are product specific (see Installation page)
<b>ACOUSTICS</b>	0.60 NRC
<b>FLAMMABILITY</b>	ASTM E84: Class A
<b>SUSTAINABILITY</b>	Made from 60% recycled content and is 100% recyclable



# Acoustic Greenery

## Specifications Replica Greenery

<b>APPEARANCE</b>	Built botanically accurate
<b>FIRE TREATMENT</b>	Injection Molded
 <b>THERMALEAFF®</b>	Inherently Fire retardant Foliage
<b>MAINTENANCE</b>	Clean with vacuum or light dusting
<b>FIRE WARRANTY</b>	Lifetime fire protection
<b>ENVIRONMENTAL</b>	LEEDv4, VOC free, 100% recyclable, non-toxic, non-allergenic, anti-microbial
<b>FIRE TESTING</b>	ASTM E84/ NFPA701/ NFPA705/ BS476
<b>SUSTAINABILITY</b>	Made from 60% recycled content and is 100% recyclable



**Lush**

<b>APPEARANCE</b>	Built botanically accurate
 <b>PERMALEAFF®</b>	Injection Molded. Excellent weathering and UV Resistant Foliage
<b>PERMALEAFF®</b>	Inherently Fade Resistant Foliage
<b>MAINTENANCE</b>	Clean with vacuum or light dusting
<b>FIRE WARRANTY</b>	Lifetime fire protection
<b>ENVIRONMENTAL</b>	LEEDv4, VOC free, 100% recyclable, non-toxic, non-allergenic, anti-microbial
<b>FADE TESTING</b>	10,000 HOURS Lab Testing/ Safe chemicals fused into plant materials during manufacturing



**Trimmed**

# Spatial Solutions



## Enhancing Connection

Greenery enhances gathering spaces, creating a warm, inviting atmosphere that fosters connection. Whether through potted plants, hanging vines, or lush centerpieces, natural elements soften the environment, improve air quality, and add vibrancy. Greenery brings a sense of calm and cohesion, making any space feel more lively and welcoming.

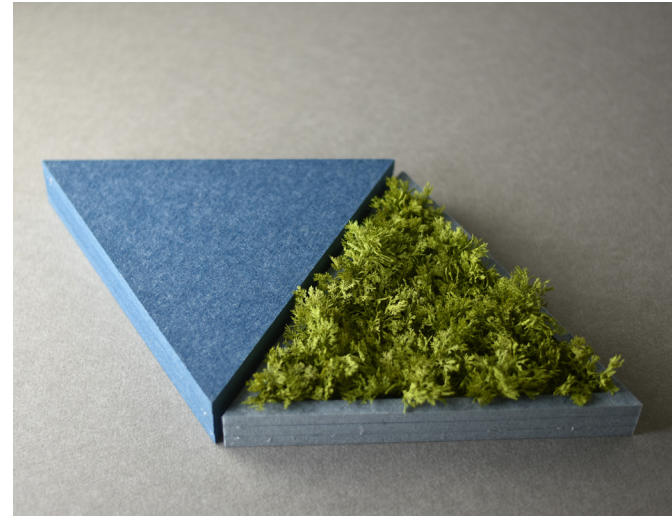

# Spatial Solutions



## Enhancing Connection

Greenery enhances gathering spaces, creating a warm, inviting atmosphere that fosters connection. Whether through potted plants, hanging vines, or lush centerpieces, natural elements soften the environment, improve air quality, and add vibrancy. Greenery brings a sense of calm and cohesion, making any space feel more lively and welcoming.



SND105  
SAND DOLLAR



SND101  
COMMODORE

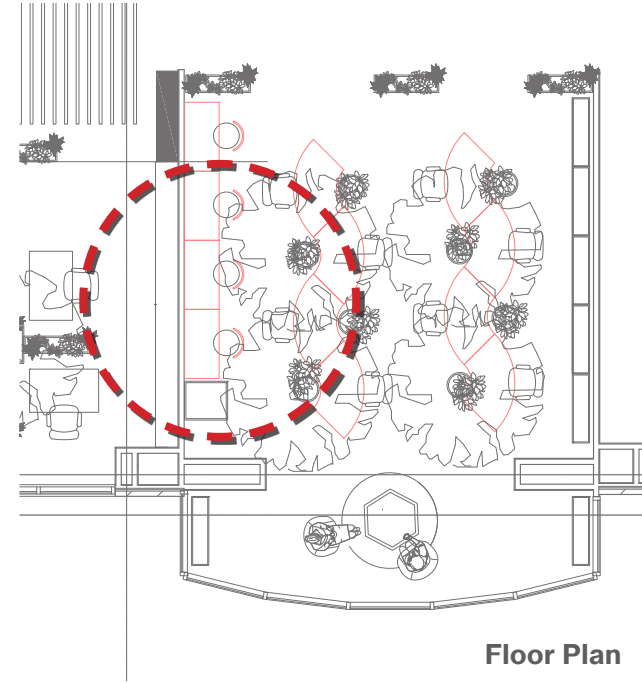
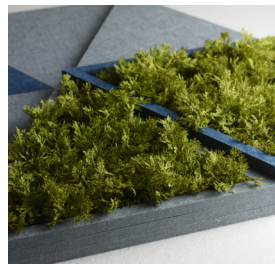

Floor Plan



Conceptual



# Spatial Solutions



## Enhancing Connection

Greenery enhances gathering spaces, creating a warm, inviting atmosphere that fosters connection. Whether through potted plants, hanging vines, or lush centerpieces, natural elements soften the environment, improve air quality, and add vibrancy. Greenery brings a sense of calm and cohesion, making any space feel more lively and welcoming.

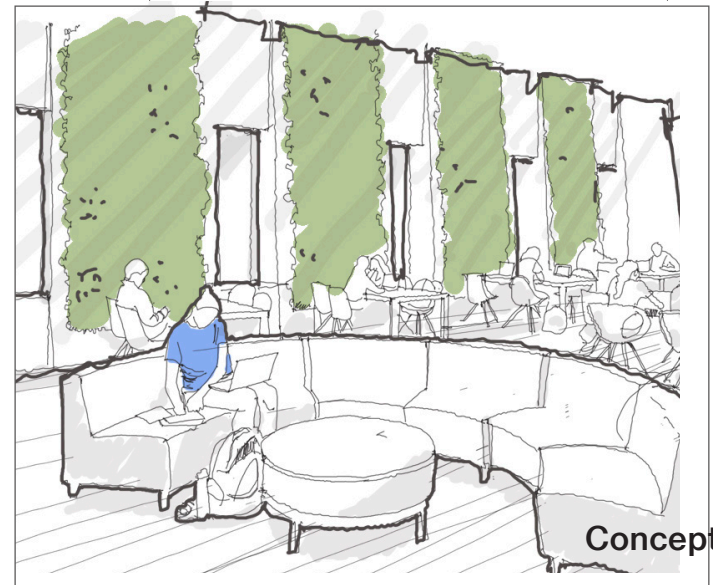
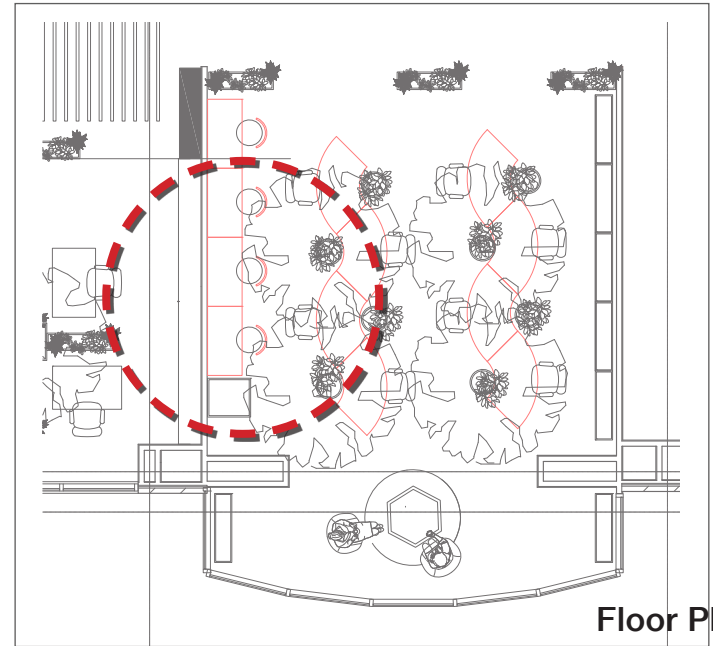

# Spatial Solutions



Greenery enhances gathering spaces, creating a warm, inviting atmosphere that fosters connection. Whether through potted plants, hanging vines, or lush centerpieces, natural elements soften the environment, improve air quality, and add vibrancy. Greenery brings a sense of calm and cohesion, making any space feel more lively and welcoming.

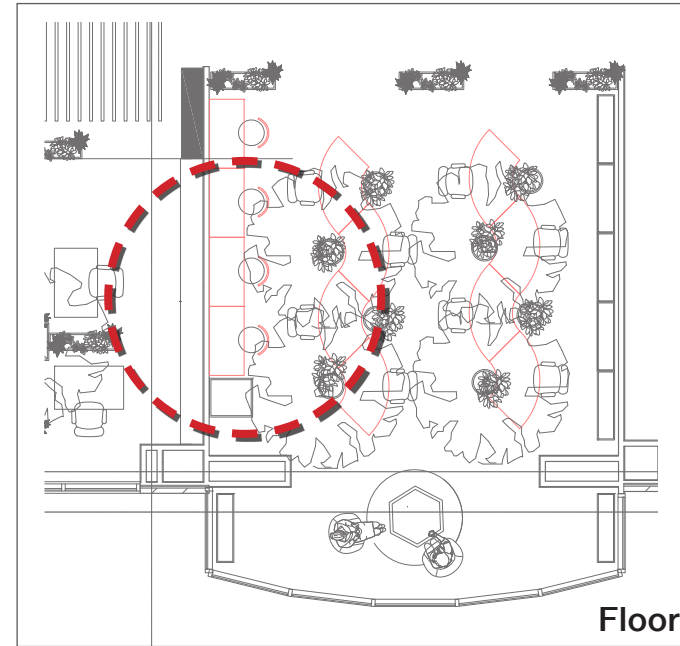

Floor Plan

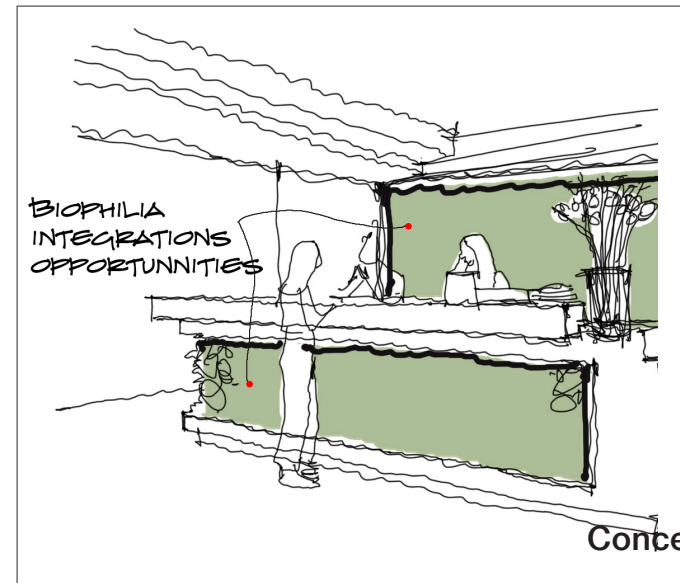

Conceptual





## What is Acoustic Greenery ?

This new product category lies at the crossroads of biophilia and acoustics, but it's more than just biophilic colors, gestures and patterns-acoustic greenery bring the beauty of the natural world inside your space with fully fledged greenery components programmed into our acoustical designs systems. Acoustic Greenery is defined as being:

### Inherently Fire Retardant

Our greenery is made with Thermaleaf® by Plantscape Commercial Silk , a proprietary flame retardant technology. Injection molded into each plant, Thermaleaf® eliminates the need for ongoing spray treatment or maintenance, ensuring longlasting safety and building fire code compliance

### Acoustical Absorbent

You may know about the acoustics benefits of our PET and wool felt, materials, but adding greenery can enhance these properties too. Depending on its density and lushness, greenery attenuates sound by trapping waves between leaves and tendrils

### Easy to specify

Like our other products, acoustic greenery can be specified within Division 09 of the CSI Master Spec, as it's integrated into the wall or ceiling product design. Contact your CSI Creative Rep for help with the 3-part specification process